

EFTS INTEGRATE COMMAND MODULATOR (ICM)

EFTS Waveform Generator

Complete EFTS RF Waveform generator that meets all EFTS specifications for use with existing EFTS devices (EFTS Flight Termination Receiver, Triple DES Unit TDU and Monitor)

INTEGRATED SOLUTION

This portable test set provides full functionality from key press to RF Out for a portable EFTS RF Signal Source

Use with Triple DES Unit (TDU)

Compatible with TDU for NSA grade encryption of EFTS Signals

User Friendly Design

Simple parameter programming allows quick changes to EFTS parameters with a tactile 4x4 hexadecimal keypad.

Large Indoor/Outdoor

Transflexive LCD Displays

Nine large Transflexive LCD Displays provide easy viewing of current parameter values

Mission Key Lock

Critical EFTS parameters can be programmed into the ICM, then locked with an integrated keylock to minimize unauthorized user changes

Test Ports

Test Points allow easy access to critical EFTS functions such as NRZ

Data Stream clock and Data, and Frame Synchronization

specifications subject to change

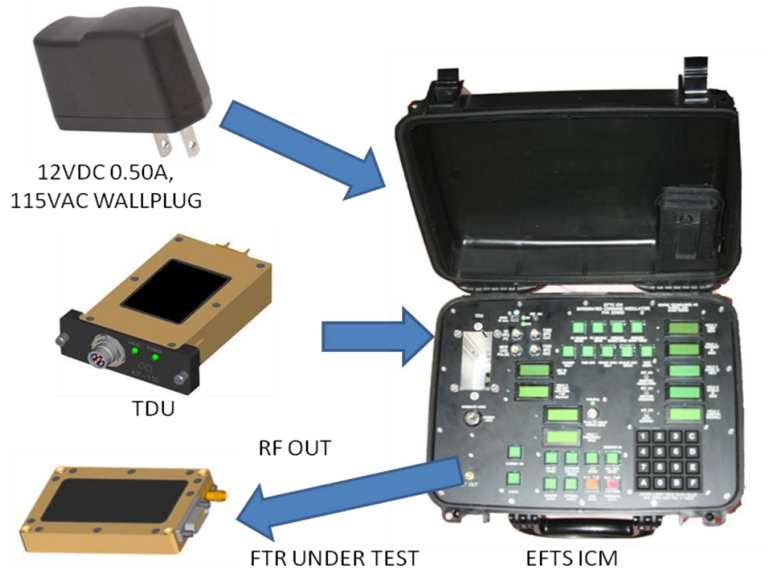

| | |
|-------------------------------------|---|
| Warranty: | 1 Year |
| Wallplug Power: | 115 VAC Wall Plug: 12V @ 500 ma DC input with 2.1mm (Included) |
| Case Size: | 14.90" x 12.13" x 9.57" |
| Operating Temperature Range: | 0°C to +40°C |
| Storage Temperature Range: | -20°C to +85°C |
| RF Output: | SMA-F |
| RF Frequency Range: | 420.0 to 450.0 MHz, Tunable in 100 kHz Steps |
| RF Frequency Deviation | +/- 50 KHz (+/- 3%) |
| RF Power Range (dBm): | -10, -5, -3, -2, -1, 0, +1 dBm, +/- 1 dB Unit is provided with suitable 20dB and 30dB Attenuators |
| RF Antenna | 3.5" ¼ wave whip provided (Centered at 433 MHz, 25 MHz Bandwidth) |
| EFTS COMMAND BUTTONS | ALL PUBLISHED EFTS COMMANDS |
| EFTS USER DEFINED FIELD | CONFIGURABLE TO ANY POSSIBLE |
| SPECIAL COMMAND FUNCTIONS | CARRIER ONLY, FRAME SYNC ONLY, BIT SYNC ONLY, INVALID COMMAND, MOMENTARY CCC1023 |
| TDU LOCATIONS | 1-50 |
| SPECIAL ENCRYPTION FUNCTIONS | TDU LOCATION 51 IS SELECTED TO USE THE EFTS PUBLISHED ENCRYPTION KEY |
| MISSION KEYLOCK FUNCTION | LOCKS EFTS PARAMETERS FROM BEING CHANGED DURING OPERATIONAL MODE |
| ARM/TERMINATE SEQUENCING | SUPPORTED SWITCH ON OR OFF |
| AUTO COUNTER | SUPPORTED SWITCH ON OR OFF |
| INVERTED MODULATION | SUPPORTED SWITCH ON OR OFF |
| TEST OUTPUTS (LOGIC LEVEL) | 7200 BPS CLOCK, 7200 BPS NRZ DATA, 50 PPS FRAME SYNC, NEW COMMAND OUTPUT PULSE |
| Weight: | < 10 lbs |
| Shock/Vibration: | The unit is designed for a test bench environment in a portable package. Do not ship or check this item into airline luggage without proper packaging. |

Merritt Island, FL
Phone 321-684-2921



Bourne Technologies
Made In FL, USA
ICM P/N Z01805

EFTS INTEGRATE COMMAND MODULATOR (ICM)

EFTS ICM Uses:

- Developmental Support
- Preflight Testing
- Portable Applications
- Training
- Multiple Source Backup

Automatically Saved State:

Current State of all parameters is saved for immediate use on power up

Standard Design Includes:

- ICM in Rugged Case
- Wideband Antenna
- Power Supply
- Switchlock Keys
- 20 dB Attenuator
- 30 dB Attenuator
- Velcro Attached Storage Case

Rugged Case Features:

- Watertight
- Airtight
- Dustproof and
- Crush resistant
- PadLock

specifications subject to change

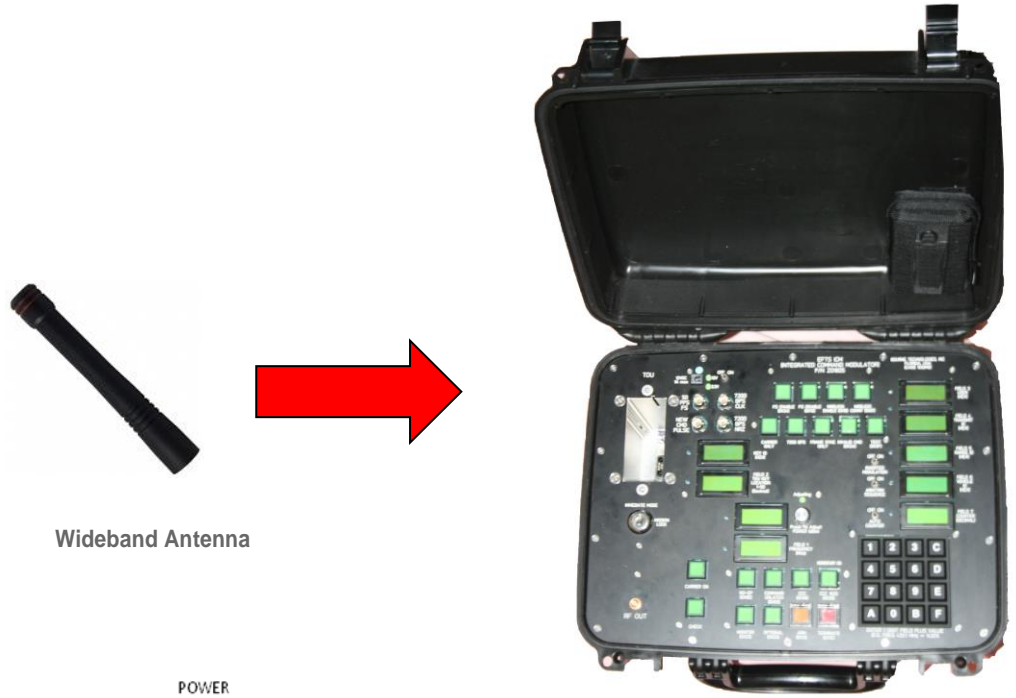

Wideband Antenna

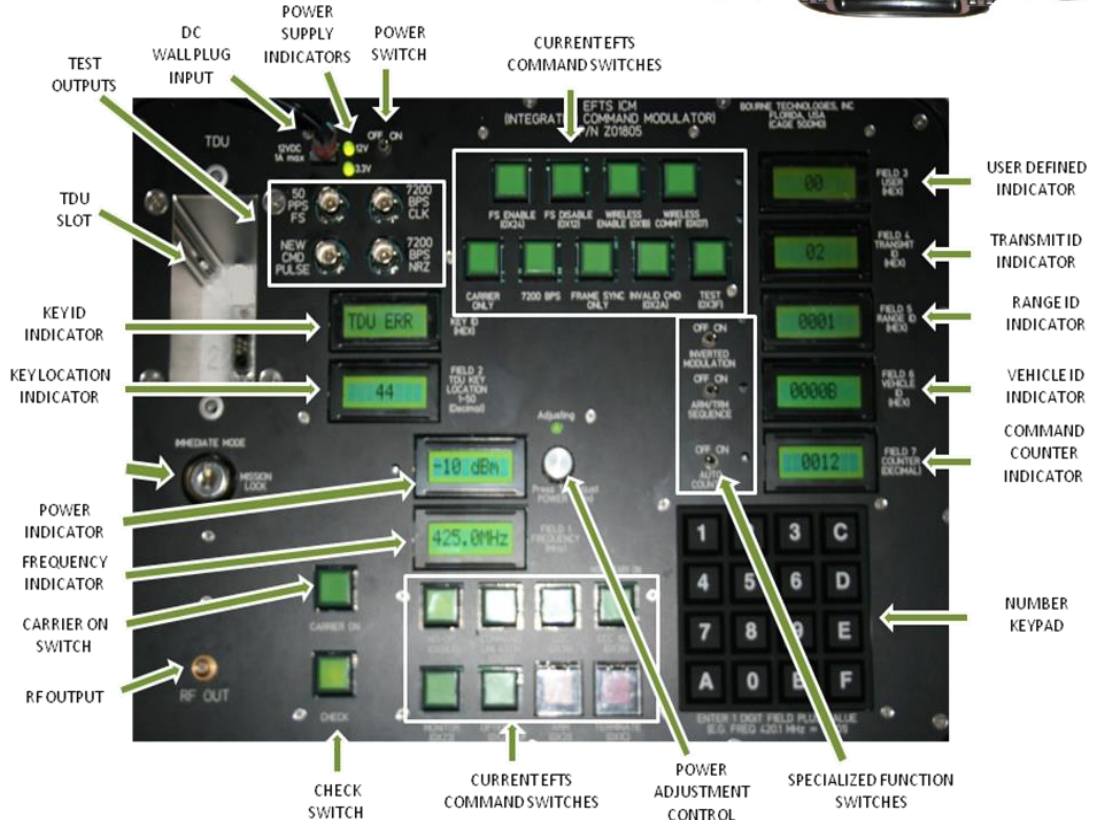

Merritt Island, FL
Phone 321-684-2921



Bourne Technologies
ICM P/N Z01805
Made In FL, USA